



ERA BIOLOGY



FungiXpert[®]

Aspergillus IgM/IgG Antibody Detection Kit (CLIA)

Product Code: FAIgM012-CLIA / FAIgG012-CLIA

Fully-automatic

- Monotest
- Unique automatic sample pre-treatment

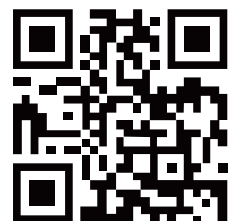

Overview

The incidence of Invasive Fungal Infection in immunosuppressed patients increases year by year due to extensive application of antibiotics, immunosuppressants and corticosteroids in clinical practice. Deep fungal infection invades the viscera and causes systemic infection, which endangers the lives of patients and leads to high mortality. Aspergillus belongs to ascomycetes, which can produce mycelium. Aspergillus is transmitted through the release of asexual spores from mycelium. Aspergillus can cause multiple allergic and invasive diseases when it enters the body. Aspergillus IgM and IgG antibodies are important indicators of aspergillus infection, and the detection of aspergillus specific antibodies is helpful for clinical diagnosis.

Product Characteristics

Basic Parameters	Aspergillus IgM Antibody Detection Kit (CLIA)	Aspergillus IgG Antibody Detection Kit (CLIA)
Method	Chemiluminescence Immunoassay, CLIA	
Sample Type	Serum	
Specification	12 Tests/Kit	
Applicable Instrument	Full-Automatic Chemiluminescence Immunoassay System (FACIS-I)	
Detection Time	40 min	
Detection Objects	<i>Aspergillus spp.</i>	
Stability	The kit is stable for 1 year at 2°C-8°C	

Product Advantages



Saving time is saving life! Obtain result within 60 min.
(Including time for automatic sample pre-treatment inside the system)

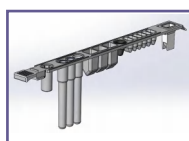

All in one! Integrated reagents and consumables together, more convenient.



Fully automatically perform experiment process & data analysis.



Tel: +86(22)60978609 ext. 8605/8606/8608/8609
Fax: +86(22)60978609-804
E-mail: marketing@era-bio.com / customer@era-bio.com
Web: www.era-bio.com



Genobio Pharmaceutical Co., Ltd.
Add: 2-1,2,3-101, No.2 Zone, Binlv Industrial Park, Binhai
Tourism Area, Binhai New Area, Tianjin 300480, P. R. China

Genobio is wholly-owned subsidiary of Era Biology Group